

# 3-1/2" x 1-1/2" x 3/16" I-Beam

## ALLOWABLE UNIFORM LOADS (lbs./ft. / N/m.)

$$A_w \text{ (in.}^2 \text{ / mm.}^2\text{)} = 0.585 \text{ / } 377.4$$

$$I \text{ (in.}^4 \text{ / mm.}^4\text{)} = 2.01 \text{ / } 836625$$

$$\text{Wt. (lbs. / kg.m.)} = 0.88 \text{ / } 1.31$$

$$S \text{ (in.}^3 \text{ / mm.}^3\text{)} = 1.15 \text{ / } 18845$$

SPAN FEET/ METERS	NO LATERAL SUPPORT		LATERALLY SUPPORTED					
	MAXIMUM LOAD	MAXIMUM LOAD	DEFLECTION					
			L/100	L/150	L/180	L/240	L/360	
4/1.22	84/984	430/6388	Fb	397/5795	264/3858	220/3213	165/2406	110/1599
5/1.52	40/461	275/4460	Fb	215/3131	143/2083	119/1733	89/1296	59/859
6/1.83	22/249	191/3093	Fb	128/1865	85/1238	71/1029	53/768	35/507
7/2.13	13/146	140/2269	Fb	82/1192	54/790	45/656	33/488	22/321
8/2.44	8/91	107/1733	Fb	55/804	36/531	30/440	22/327	15/213
9/2.74	5/59	84/1367	Fb	39/566	26/372	21/308	16/227	10/147
10/3.05	4/38	68/1104	Fb	28/411	18/269	15/222	11/163	7/104

The part weight has been deducted in the above table.

This item is stocked in 20-foot lengths in Polyester Fire Retardant (FR).

Other lengths available in mill run quantities.

The mill run on this item is 1000 feet.

Orders for less than mill run quantities will be subject to set-up charges as well as premium per foot cost.

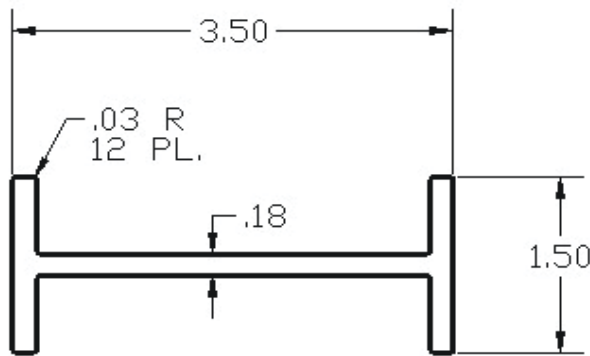

	PROJECT NAME AND LOCATION:	THIS DRAWING IS THE SOLE PROPERTY OF COOLING TOWER DEPOT INC. USE SHALL BE LIMITED TO THE PROJECT FOR WHICH IT IS INTENDED, NO REPRODUCTION SHALL BE MADE NOR SHALL THIS INFORMATION BE MADE AVAILABLE TO THIRD PARTIES WITHOUT THE PRIOR WRITTEN CONSENT BY COOLING TOWER DEPOT INC. ANY AND ALL PROPRIETARY RIGHTS TO THIS INFORMATION AND DESIGN ARE THE SOLE PROPERTY OF COOLING TOWER DEPOT INC.				COOLING TOWER DEPOT, INC CORPORATE CIRCLE GOLDEN, CO 80401 720-746-1234	JOB NUMBER:	0	REV. NO.	0
	MODEL NO.:	REVISIONS					SCALE:	NO SCALE	DATE:	1
	DWG NAME:	REV.	DESCRIPTION	DESIGNED BY:	CHECKED BY:		APPROVED BY:	NO SCALE	1	1
	DRAWING NUMBER: A-100	JOB NUMBER:	SHEET 1 of 1	REV: 0						
SCALE: NO SCALE	COMMENTS:									